

**DIN 934** similar to ISO 4032

## Hexagon nuts

External hex

Steel 8 | bright | Cr(VI)-free | Metric left-handed thread

Further information: DIN-standard has been withdrawn | changed spanner widths for M10, M12, M14 and M22 | the fine thread has been transferred to ISO 8673

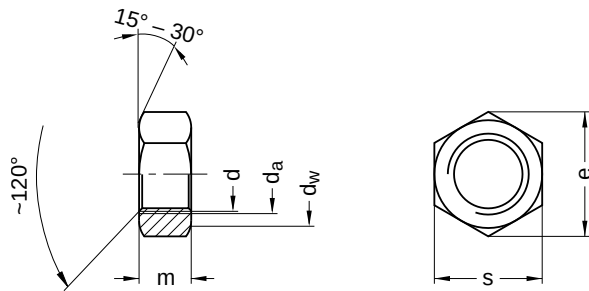

Diameter (d)	da		dw	e	m		s		Pitch (P)	Tool size
	min.	max.			min.	max.	min.	max.		
M 5	5	5.75	6.8	8.79	3.70	4.0	7.78	8	0.80	SW 8
M 6	6	6.75	8.8	11.05	4.70	5.0	9.78	10	1.00	SW 10
M 8	8	8.75	11.3	14.38	6.14	6.5	12.73	13	1.25	SW 13
M 10	10	10.80	15.3	18.90	7.64	8.0	16.73	17	1.50	SW 17
M 12	12	13.00	17.2	21.10	9.64	10.0	18.67	19	1.75	SW 19
M 16	16	17.30	22.2	26.75	12.30	13.0	23.67	24	2.00	SW 24
M 24	24	25.90	33.2	39.55	17.70	19.0	35.00	36	3.00	SW 36
M 30	30	32.40	42.7	50.65	22.70	24.0	45.00	46	3.50	SW 46

All technical data refer to the measure mm

