



Hexalobular / TORX®

Efficient assembly

BÖLLHOFF

Hexalobular / TORX®

Torx (English Torque) is the brand name for a screw-drive profile in multi-circular shape. It is handled as a further development of the crossed slot and hexagon socket drive.

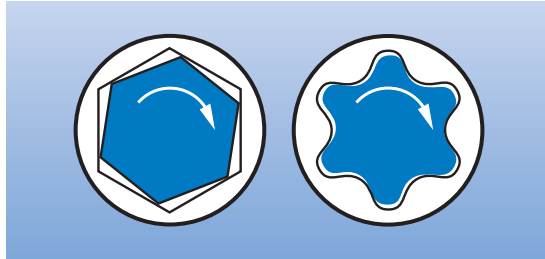

■ **Efficient assembly**

The mounting forces are not by edges but transmitted by driving surfaces. The size of the driving surfaces ensures the optimum power transmission. Very high torques can be also transmitted without damaging the head. The corrosion protection is maintained.

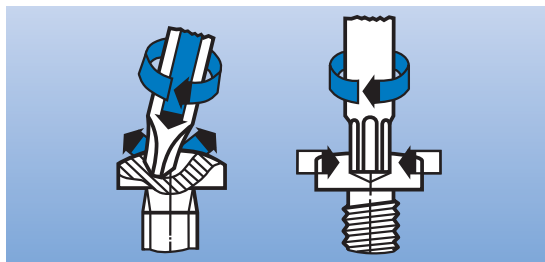

■ **Reducing tooling costs**

The wave profile facilitates the touchdown of the tool. The driving forces are perpendicular. There are no reverse thrust forces (Cam out-effect). The life of the assembly tools increases thereby significantly.

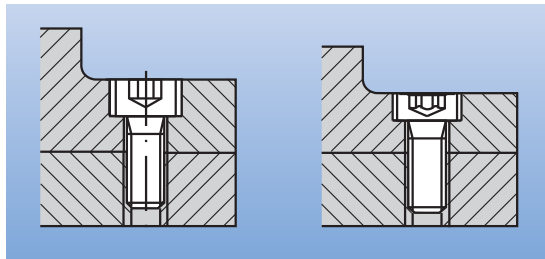

■ **Small footprint**

The screw head is compared to other actuators smaller and requires less material. Despite of small footprint can be transferred a higher torque.

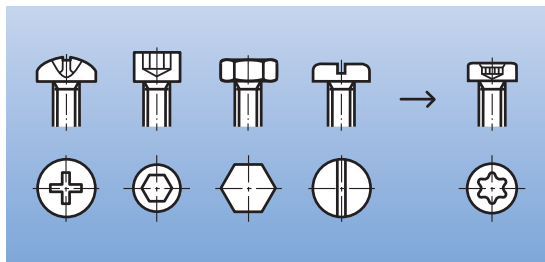

■ **Large standardization potential**

One drive system can be used for many different screws. This reduces the expenses for tools, stock and logistics costs. Screws with low or flat heads can be mounted easily.

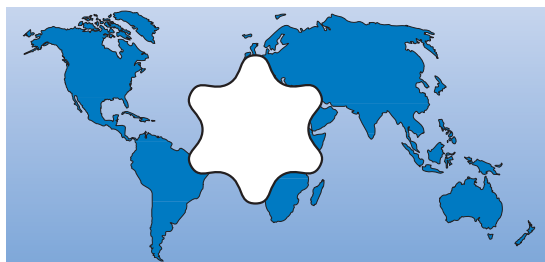

■ **Global applicability**

Hexalobular / Torx® drive systems are now used by default in the automotive industry, machinery, electronics and many other industries worldwide. In standard toolboxes are Hexalobular / Torx® bits commercially available.

Hexalobular / TORX®

B 7380 · 10.9 · Button screws

Hexalobular drive

Zinc plated, similar to ISO 7380

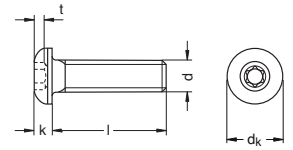

Technical information

d	dk max.	Drive size	kmax.	t _{min.}
M 4	7,60	TX 20	2,20	1,27
M 5	9,50	TX 25	2,75	1,52
M 6	10,50	TX 30	3,30	1,90

d	l	d	l	d	l
M 4	6	M 4	20	M 5	20
M 4	8	M 5	8	M 5	25
M 4	10	M 5	10	M 6	16
M 4	12	M 5	12	M 6	20
M 4	16	M 5	16	M 6	25

B 7380 · A2 · Button screws

Hexalobular drive

Similar to ISO 7380

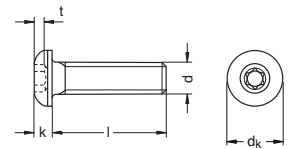

Technical information

d	dk max.	Drive size	kmax.	t _{min.}
M 4	7,60	TX 20	2,20	1,27
M 5	9,50	TX 25	2,75	1,52
M 6	10,50	TX 30	3,30	1,90
M 8	14,00	TX 40	4,40	2,55

d	l	d	l	d	l
M 4	8	M 5	12	M 6	25
M 4	10	M 5	16	M 8	12
M 4	12	M 5	20	M 8	16
M 4	16	M 6	10	M 8	20
M 4	20	M 6	12	M 8	25
M 5	8	M 6	16	M 8	30
M 5	10	M 6	20	M 8	35

LFS · 10.9

Flange Button Head Socket screws with hexalobular drive

Zinc plated

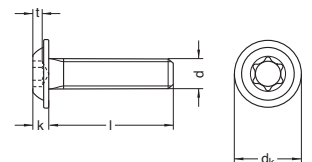

Technical information

d	dk max.	Drive size	kmax.	t _{min.}
M 4	9,40	TX 10	2,20	1,25
M 5	11,80	TX 25	2,85	1,56
M 6	13,60	TX 30	3,35	1,80

d	l	d	l	d	l
M 4	8	M 5	12	M 6	16
M 4	10	M 5	16	M 6	20
M 4	12	M 5	20	M 6	25
M 4	16	M 5	25		
M 5	10	M 6	12		

Hexalobular / TORX®

DIN 7500 · Thread rolling screws

Pan Head with hexalobular drive, for metric ISO-thread,

Version C, form Duo

Case hardened

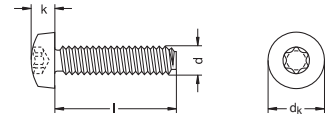

Technical information

d	dk max.	Drive size	k _{max.}
M 2,5	5,00	TX 8	2,12
M 3	6,00	TX 10	2,52
M 4	8,00	TX 20	3,25
M 5	10,00	TX 25	3,95
M 6	12,00	TX 30	4,75

d	l	d	l	d	l
M 2,5	5	M 4	6	M 5	20
M 2,5	6	M 4	8	M 5	25
M 2,5	8	M 4	10	M 6	10
M 2,5	10	M 4	12	M 6	12
M 3	5	M 4	16	M 6	16
M 3	6	M 4	20	M 6	20
M 3	8	M 5	8	M 6	25
M 3	10	M 5	10	M 6	30
M 3	12	M 5	12		
M 3	16	M 5	16		

DIN 7500 · Thread rolling screws

Countersunk Head with hexalobular drive, for metric ISO-thread,

Version M, form Duo

Case hardened, zinc plated

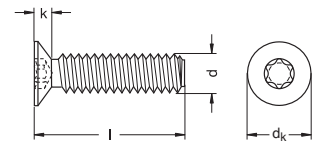

Technical information

d	dk max.	Drive size	k _{max.}
M 2,5	4,70	TX 8	1,50
M 3	5,60	TX 10	1,65
M 4	7,50	TX 20	2,20
M 5	9,20	TX 25	2,50
M 6	11,00	TX 30	3,00

d	l	d	l	d	l
M 2,5	6	M 4	10	M 5	25
M 2,5	8	M 4	12	M 6	10
M 2,5	10	M 4	16	M 6	12
M 3	6	M 4	20	M 6	16
M 3	8	M 4	25	M 6	20
M 3	10	M 5	10	M 6	25
M 3	12	M 5	12	M 6	30
M 3	16	M 5	16		
M 4	8	M 5	20		

Hexalobular / TORX®

B 7984 · 8.8 · Low Head Capscrews

Hexalobular drive

Zinc plated, similar to DIN 7984, ISO 14580

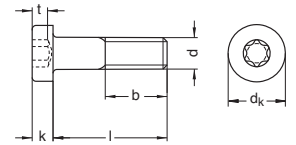

Technical information

d	dk max.	Drive size	b	k _{max.}	t _{min.}
M 3	5,50	TX 10	12	2,40	1,01
M 4	7,00	TX 20	14	3,10	1,27
M 5	8,50	TX 25	16	3,70	1,52
M 6	10,00	TX 30	18	4,60	1,90
M 8	13,00	TX 45	22	6,00	2,66

d	l	d	l	d	l
M 3	6	M 4	12	M 6	20
M 3	8	M 4	16	M 6	25
M 3	10	M 5	12	M 8	16
M 3	12	M 5	16	M 8	20
M 3	16	M 5	20	M 8	25
M 4	6	M 5	25	M 8	30
M 4	8	M 6	12		
M 4	10	M 6	16		

DIN 7985 · 4.8 · Pan Head screws

Hexalobular drive

Zinc plated, similar to DIN EN ISO 14583

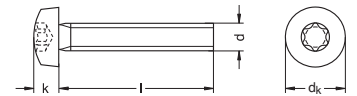

Technical information

d	dk max.	Drive size	k _{max.}
M 3	6,00	TX 10	2,4
M 4	8,00	TX 20	3,1
M 5	10,00	TX 25	3,8
M 6	12,00	TX 30	4,6

d	l	d	l	d	l
M 3	5	M 4	20	M 5	35
M 3	6	M 4	25	M 5	40
M 3	8	M 4	30	M 6	8
M 3	10	M 4	35	M 6	10
M 3	12	M 4	40	M 6	12
M 3	16	M 5	8	M 6	16
M 3	20	M 5	10	M 6	20
M 4	6	M 5	12	M 6	25
M 4	8	M 5	16	M 6	30
M 4	10	M 5	20	M 6	35
M 4	12	M 5	25	M 6	40
M 4	16	M 5	30	M 6	50

Hexalobular / TORX®

ISO 14583 · A2 · Pan Head screws

Hexalobular drive

Similar to DIN 7985

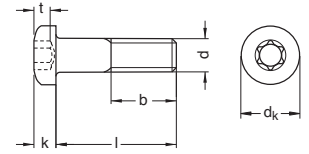

Technical information

d	dk max.	Drive size	b	k _{max.}	t _{min.}
M 3	5,60	TX 10	25	2,40	1,01
M 4	8,00	TX 20	38	3,10	1,27
M 5	9,50	TX 25	38	3,70	1,52
M 6	12,00	TX 30	38	4,60	2,02

d	l	d	l	d	l
M 3	6	M 4	10	M 5	25
M 3	8	M 4	12	M 6	12
M 3	10	M 4	16	M 6	16
M 3	12	M 4	20	M 6	20
M 3	16	M 5	12	M 6	25
M 4	6	M 5	16		
M 4	8	M 5	20		

ISO 14579 · 8.8 · TORX® Capscrews

Hexalobular drive

Zinc plated, similar to DIN 912

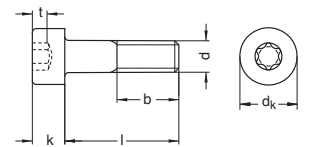

Technical information

d	dk max.	Drive size	b	k _{max.}	t _{min.}
M 4	7,22	TX 20	20	4,00	1,80
M 5	8,72	TX 25	22	5,00	2,03
M 6	10,22	TX 30	24	6,00	2,42
M 8	13,07	TX 45	28	8,00	3,31

d	l	d	l	d	l
M 4	6	M 5	16	M 8	16
M 4	8	M 5	20	M 8	20
M 4	10	M 6	16	M 8	25
M 4	12	M 6	20	M 8	30
M 5	12	M 6	25	M 8	35

ISO 14579 · A2 · TORX® Capscrews

Hexalobular drive

similar to DIN 912

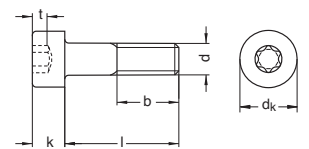

Technical information

d	dk max.	Drive size	b	k _{max.}	t _{min.}
M 4	7,60	TX 20	20	2,20	1,80
M 5	9,50	TX 25	22	2,75	2,03
M 6	10,50	TX 30	24	3,30	2,42
M 8	14,00	TX 40	28	4,40	3,31

d	l	d	l	d	l
M 3	6	M 4	10	M 5	25
M 3	8	M 4	12	M 6	12
M 3	10	M 5	10	M 6	16
M 3	12	M 5	12	M 6	20
M 4	6	M 5	16	M 6	25
M 4	8	M 5	20		

Hexalobular / TORX®

B 52100 · 8.8 · Countersunk Head screws

Hexalobular drive

Zinc plated, similar to ISO 10642, DIN 7991, ISO 14581, ISO 7046, DIN 965

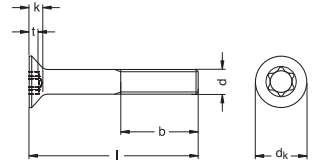

Technical information

d	dk	Drive size	b	k _{max.}	t _{min.}
M 3	6,72	TX 10	18	1,86	0,80
M 4	8,96	TX 20	20	2,48	0,95
M 5	11,20	TX 25	22	3,10	1,10
M 6	13,44	TX 30	24	3,72	1,40

d	l	d	l	d	l
M 3	5	M 4	12	M 5	30
M 3	6	M 4	16	M 5	35
M 3	8	M 4	20	M 5	40
M 3	10	M 4	25	M 6	12
M 3	12	M 4	30	M 6	16
M 3	16	M 5	8	M 6	20
M 3	20	M 5	10	M 6	25
M 4	5	M 5	12	M 6	30
M 4	6	M 5	16	M 6	35
M 4	8	M 5	20	M 6	40
M 4	10	M 5	25		

B 52100 · A2 · Countersunk Head screws

Hexalobular drive

Similar to ISO 10642, DIN 7991, ISO 14581, ISO 7046, DIN 965

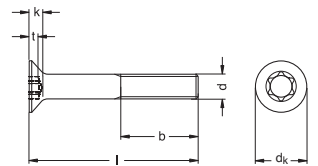

Technical information

d	dk	Drive size	b	k _{max.}	t _{min.}
M 3	6,72	TX 10	18	1,86	0,80
M 4	8,96	TX 20	20	2,48	0,95
M 5	11,20	TX 25	22	3,10	1,10
M 6	13,44	TX 30	24	3,72	1,40
M 8	17,92	TX 40	28	4,96	1,75

d	l	d	l	d	l
M 3	5	M 4	25	M 6	16
M 3	6	M 4	30	M 6	20
M 3	8	M 4	35	M 6	25
M 3	10	M 4	40	M 6	30
M 3	12	M 5	8	M 6	35
M 3	16	M 5	10	M 6	40
M 3	20	M 5	12	M 8	12
M 3	25	M 5	16	M 8	16
M 3	30	M 5	20	M 8	20
M 4	6	M 5	25	M 8	25
M 4	8	M 5	30	M 8	30
M 4	10	M 5	35	M 8	35
M 4	12	M 5	40	M 8	40
M 4	16	M 6	10		
M 4	20	M 6	12		

Hexalobular / TORX®

**DIN 7981 · Self tapping screws with TORX®
Pan Head**

Hexalobular drive, form C with cone point
Case hardened, similar to DIN EN ISO 14585

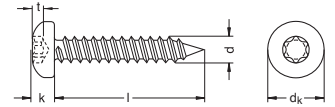

Technical information

d	dk max.	Drive size	kmax.	tmin.
2,9	5,60	TX 10	2,4	1,01
3,5	7,00	TX 15	2,6	1,14
3,9*	7,50	TX 20	2,8	1,40
4,2	8,00	TX 20	3,1	1,42
4,8	9,50	TX 25	3,7	1,65

* Measurement isn't standardised

d	l	d	l	d	l
2,9	6,5	3,9*	13,0	4,2	38,0
2,9	9,5	3,9*	16,0	4,2	45,0
2,9	13,0	3,9*	19,0	4,2	50,0
2,9	16,0	3,9*	22,0	4,8	9,5
2,9	19,0	3,9*	25,0	4,8	13,0
2,9	22,0	3,9*	32,0	4,8	16,0
3,5	9,5	3,9*	38,0	4,8	19,0
3,5	13,0	3,9*	45,0	4,8	22,0
3,5	16,0	4,2	9,5	4,8	25,0
3,5	19,0	4,2	13,0	4,8	32,0
3,5	22,0	4,2	16,0	4,8	38,0
3,5	25,0	4,2	19,0	4,8	45,0
3,5	32,0	4,2	22,0	4,8	50,0
3,5	38,0	4,2	25,0		
3,9*	9,5	4,2	32,0		

* Measurement isn't standardised

**ISO 14585 · A2 · Self tapping screws with TORX®
Pan Head**

Hexalobular drive, form C with cone point
Case hardened, similar to DIN 7981

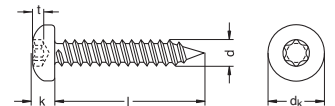

Technical information

d	dk max.	Drive size	kmax.	tmin.
2,9	5,60	TX 10	2,40	1,01
3,5	7,00	TX 15	2,60	1,14
4,2	8,00	TX 20	3,10	1,42
4,8	9,50	TX 25	3,70	1,65

d	l	d	l	d	l
2,9	9,5	3,5	22,0	4,8	19,0
2,9	13,0	4,2	13,0	4,8	22,0
2,9	16,0	4,2	16,0	4,8	25,0
2,9	19,0	4,2	19,0	4,8	32,0
3,5	9,5	4,2	22,0	4,8	38,0
3,5	13,0	4,2	25,0	4,8	45,0
3,5	16,0	4,8	13,0		
3,5	19,0	4,8	16,0		

Hexalobular / TORX®

ISO 14586 · Self tapping screws with Countersunk Head

Hexalobular drive, form C with cone point

Case hardened, zinc plated, similar to DIN 7982

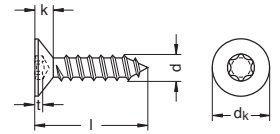

Technical information

d	dk max.	Drive size	k _{max.}	t _{min.}
2,9	5,50	TX 10	1,70	0,65
3,5	7,30	TX 15	2,35	1,00
3,9*	7,50	TX 15	2,30	1,20
4,2	8,40	TX 20	2,60	1,14
4,8	9,30	TX 25	2,80	1,39

* Measurement isn't standardised

d	l	d	l	d	l
2,9	9,5	3,9	13,0	4,2	25,0
2,9	13,0	3,9	16,0	4,8	16,0
2,9	16,0	3,9	19,0	4,8	19,0
2,9	19,0	3,9	22,0	4,8	22,0
3,5	9,5	3,9	25,0	4,8	25,0
3,5	13,0	4,2	13,0	4,8	32,0
3,5	16,0	4,2	16,0	4,8	38,0
3,5	19,0	4,2	19,0		
3,5	22,0	4,2	22,0		

ISO 14586 · A2 · Self tapping screws with Countersunk Head

Hexalobular drive, form C with cone point

Case hardened, similar to DIN 7982

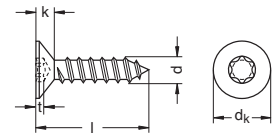

Technical information

d	dk max.	Drive size	k _{max.}	t _{min.}
2,9	5,50	TX 10	1,70	0,65
3,5	7,30	TX 15	2,35	1,00
3,9*	7,50	TX 15	2,30	1,20
4,2	8,40	TX 20	2,60	1,14
4,8	9,30	TX 25	2,80	1,39

* Measurement isn't standardised

d	l	d	l	d	l
2,9	9,5	3,9	16,0	4,2	25,0
2,9	13,0	3,9	19,0	4,8	16,0
2,9	16,0	3,9	22,0	4,8	19,0
3,5	9,5	3,9	25,0	4,8	22,0
3,5	13,0	4,2	13,0	4,8	25,0
3,5	16,0	4,2	16,0	4,8	32,0
3,5	19,0	4,2	19,0		
3,9	13,0	4,2	22,0		

Hexalobular / TORX®

B 15481 · Self drilling screws with Pan Head

Hexalobular drive

Case hardened, zinc plated, similar to ISO 15481, DIN 7504-M

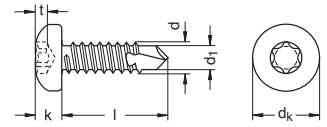

Technical information

d	dk max.	Drive size	d ₁ max.	k _{max.}	t _{min.}
3,5	7,00	TX 15	2,8	2,60	1,14
4,2	8,00	TX 20	3,6	3,10	1,42
4,8	9,50	TX 25	4,1	3,70	1,65

d	l	d	l	d	l
3,5	13,0	4,2	19,0	4,8	19,0
3,5	16,0	4,2	22,0	4,8	22,0
3,5	19,0	4,2	25,0	4,8	25,0
3,5	22,0	4,2	32,0	4,8	32,0
4,2	13,0	4,8	13,0	4,8	38,0
4,2	16,0	4,8	16,0	4,8	45,0

B 15482 · Self drilling screws with Countersunk Head

Hexalobular drive

Case hardened, similar to ISO 15482, DIN 7504-O

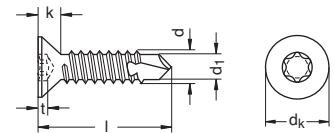

Technical information

d	dk max.	Drive size	d ₁ max.	k _{max.}	t _{min.}
3,5	7,30	TX 15	2,8	2,35	1,14
4,2	8,40	TX 20	3,6	2,60	1,42
4,8	9,30	TX 25	4,1	2,80	1,65

d	l	d	l	d	l
3,5	13,0	4,2	19,0	4,8	25,0
3,5	16,0	4,2	22,0	4,8	32,0
3,5	19,0	4,2	25,0	4,8	38,0
4,2	13,0	4,8	19,0		
4,2	16,0	4,8	22,0		

Hexalobular / TORX®

E 1452 · EJOT®-PT-screws

For thermoplastic materials

Pan Head, hexalobular drive, heat-treated steel, zinc plated

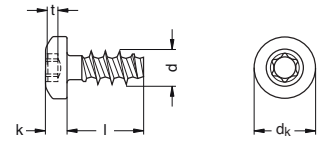

Technical information

d	dk	Drive size	k _{max.}	t _{min.}
2,0	3,60	TX 6	1,5	0,70
2,2	4,00	TX 6	1,4	0,70
2,5	4,20	TX 8	1,6	0,70
3,0	5,60	TX 10	2,1	1,00
3,5	6,90	TX 10	2,3	1,10
4,0	7,50	TX 20	2,6	1,25

d	l	d	l	d	l
2,0	5	2,5	12	3,5	20
2,0	6	2,5	16	3,5	25
2,0	8	3,0	6	3,5	30
2,0	10	3,0	8	4,0	8
2,2	5	3,0	10	4,0	10
2,2	6	3,0	12	4,0	12
2,2	8	3,0	16	4,0	16
2,2	10	3,5	8	4,0	20
2,5	6	3,5	10	4,0	25
2,5	8	3,5	12	4,0	30
2,5	10	3,5	16		

E 5451 · EJOT®-Delta-PT-screws

For thermoplastic materials

Flange Button screw, Torx-Plus/Autosert-drive, heat-treated steel

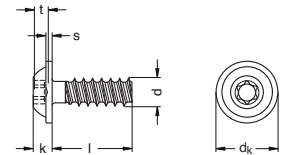

Technical information

d	dk	Drive size	k _{max.}	t _{min.}	s
2,2	5,00	TX 6	1,6	0,65	0,6
2,5	5,50	TX 8	1,9	0,80	0,7
3,0	6,50	TX 10	2,3	1,00	0,8
3,5	7,50	TX 15	2,7	1,10	0,9
4,0	9,00	TX 20	3,1	1,40	1,0
5,0	11,00	TX 25	3,5	1,50	1,2
6,0	13,50	TX 30	4,2	1,90	1,4

d	l	d	l	d	l
2,2	5	3,0	20	4,0	25
2,2	6	3,0	25	5,0	12
2,2	8	3,5	8	5,0	14
2,2	10	3,5	10	5,0	16
2,5	6	3,5	12	5,0	18
2,5	8	3,5	16	5,0	20
2,5	10	3,5	20	5,0	25
2,5	12	3,5	25	5,0	30
3,0	6	3,5	30	6,0	14
3,0	8	4,0	10	6,0	16
3,0	10	4,0	12	6,0	18
3,0	12	4,0	14	6,0	20
3,0	14	4,0	16	6,0	25
3,0	16	4,0	18	6,0	30
3,0	18	4,0	20		

Hexalobular / TORX®

E 5454 · EJOT®-Delta PT-screws

For thermoplastic materials

Countersunk Head, Torx-Plus/Autosert-drive, heat-treated steel

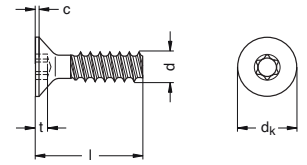

Technical information

d	dk	Drive size	t _{min.}	C _{max.}
2,2	4,40	TX 6	0,50	0,35
2,5	5,00	TX 8	0,70	0,55
3,0	6,00	TX 10	0,75	0,55
3,5	7,00	TX 15	0,95	0,65

d	l	d	l	d	l
2,2	6	2,5	12	3,5	10
2,2	8	3,0	8	3,5	12
2,2	10	3,0	10	3,5	16
2,5	8	3,0	12	3,5	20
2,5	10	3,0	16		

B 52004 · 10 · AMTEC® screws

For thermoplastic materials

Pan Head with hexalobular drive

Zinc plated

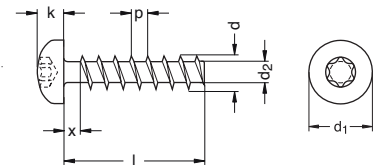

Technical information

d	d ₁	d ₂	k	X _{max.}	p	Drive size
2,5	4,70	1,6	1,6	2,2	1,12	T 8
3,0	5,60	1,9	2,1	2,8	1,40	T 10
3,5	6,50	2,1	2,3	3,2	1,60	T 10
4,0	7,50	2,3	2,6	3,6	1,80	T 20
5,0	9,20	2,8	2,9	4,6	2,20	T 20

d	l	d	l	d	l
2,5	6	3,0	16	4,0	12
2,5	8	3,5	8	4,0	16
2,5	10	3,5	10	4,0	20
3,0	6	3,5	12	4,0	25
3,0	8	3,5	16	5,0	16
3,0	10	3,5	20	5,0	20
3,0	12	4,0	8		
3,0	14	4,0	10		

Hexalobular / TORX®

B 52005 · 10 · AMTEC® screws

For thermoplastic materials
Countersunk Head with hexalobular drive
 Zinc plated

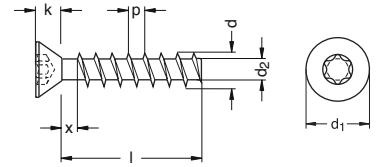

Technical information

d	d ₁	d ₂	k	X _{max.}	p	Drive size
2,5	4,70	1,6	1,7	2,2	1,12	T 8
3,0	5,50	1,9	1,8	2,8	1,40	T 8
3,5	7,30	2,1	2,5	3,2	1,60	T 15
4,0	8,40	2,3	2,9	3,6	1,80	T 20

d	l	d	l	d	l
2,5	8	3,0	12	3,5	12
3,0	8	3,0	16	4,0	12
3,0	10	3,5	10	4,0	16

B 52006 · 10 · AMTEC® screws

For thermoplastic materials
Flange Button screw, hexalobular drive
 Zinc plated

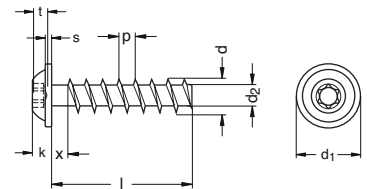

Technical information

d	d ₁	d ₂	k	X _{max.}	p	Drive size
2,5	5,00	1,6	1,5	2,2	1,12	T 6
3,0	6,00	1,9	2,1	2,8	1,40	T 10
3,5	7,00	2,1	2,4	3,2	1,60	T 10
4,0	8,00	2,3	2,6	3,6	1,80	T 20

d	l	d	l	d	l
2,5	6	3,0	10	4,0	8
2,5	8	3,0	12	4,0	10
2,5	10	3,5	8	4,0	12
3,0	6	3,5	10	4,0	16
3,0	8	3,5	12	4,0	20

Hexalobular / TORX®

B 7505 · Chipboard screws with countersunk head

Hexalobular drive

Zinc plated

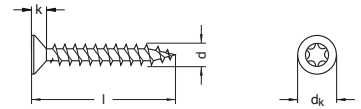

Technical information

d	dk max.	Drive size	k _{max.}
3,0	6,00	TX 10	1,9
3,5	7,00	TX 15	2,1
4,0	8,00	TX 20	2,5
4,5	9,00	TX 25	2,7
5,0	10,00	TX 25	3,0
6,0	12,00	TX 30	3,6

d	l	d	l	d	l
3,0	16	4,0	50	5,0	60
3,0	20	4,0	55	5,0	70
3,0	25	4,0	60	5,0	80
3,0	30	4,5	20	5,0	90
3,0	35	4,5	25	5,0	100
3,0	40	4,5	30	6,0	40
3,5	13	4,5	35	6,0	45
3,5	15	4,5	40	6,0	50
3,5	16	4,5	45	6,0	60
3,5	20	4,5	50	6,0	70
3,5	25	4,5	55	6,0	80
3,5	30	4,5	60	6,0	90
3,5	35	4,5	70	6,0	100
3,5	40	5,0	20	6,0	110
4,0	15	5,0	25	6,0	120
4,0	20	5,0	30	6,0	130
4,0	25	5,0	35	6,0	140
4,0	30	5,0	40	6,0	150
4,0	35	5,0	45	6,0	160
4,0	40	5,0	50		
4,0	45	5,0	55		

B 7505 · A2 · Chipboard screws with countersunk head

Hexalobular drive

Stainless steel

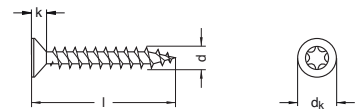

Technical information

d	dk max.	Drive size	k _{max.}
4,0	8,00	TX 20	2,5
4,5	9,00	TX 25	2,7
5,0	10,00	TX 25	3,0

d	l	d	l	d	l
4,0	20	4,0	45	4,5	50
4,0	25	4,0	50	5,0	40
4,0	30	4,5	30	5,0	50
4,0	35	4,5	35	5,0	60
4,0	40	4,5	40	5,0	70

Hexalobular / TORX®

B 51022 · Screwdriver bits

For hexalobular drive

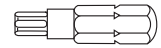

Technical information

Size	Length	Drive	Box qty.	Order-No.
TX 6	Normal (25 mm)	1/4" Outer hexagon	10	51022NTX6
TX 8	Normal (25 mm)	1/4" Outer hexagon	10	51022NTX8
TX 10	Normal (25 mm)	1/4" Outer hexagon	10	51022NTX10
TX 15	Normal (25 mm)	1/4" Outer hexagon	10	51022NTX15
TX 20	Normal (25 mm)	1/4" Outer hexagon	10	51022NTX20
TX 25	Normal (25 mm)	1/4" Outer hexagon	10	51022NTX25
TX 30	Normal (25 mm)	1/4" Outer hexagon	10	51022NTX30
TX 40	Normal (25 mm)	1/4" Outer hexagon	10	51022NTX40



www.blaueseiten-online.de
www.boellhoff.com

Böllhoff International with companies in:

Argentina
Austria
Brazil
Canada
China
Czech Republic
France
Germany
Hungary
India
Italy
Japan
Mexico
Poland
Romania
Russia
Slovakia
Spain
Switzerland
Turkey
United Kingdom
USA

Apart from these 22 countries, Böllhoff supports its international customers in other important industrial markets in close partnership with agents and dealers.



Made of paper certified with the Ecolab of the European Community (Reg No. FR/11/003).
Printed by FSC®-certified company GFA-COC-001790.

Subject to technical change.
Reprinting, even in extract form, only permitted with express consent.
Observe protective note according to DIN 34.

Böllhoff GmbH
Archimedesstraße 1-4 · 33649 Bielefeld · Germany
Phone +49 (0)521 / 44 82-03 (952) · Fax +49 (0)521 / 44 82-9 39 52
www.boellhoff.com · fastenerservicesupply@boellhoff.com

