

DIN 604
Countersunk bolts

With nib | with hexagon nut

Steel 4.6 | bright | Cr(VI)-free | Metric thread

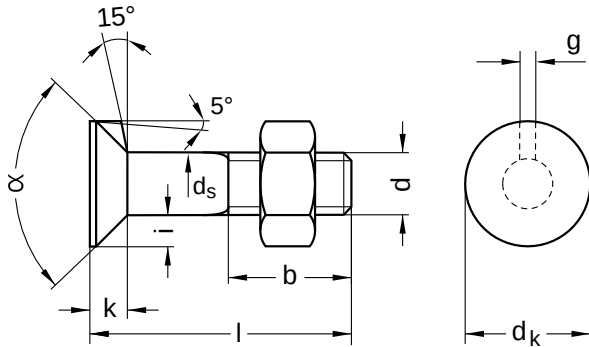

Diameter (d)	b			d _k		d _s		g		i	k nominal size	Pitch (P)
	l up to 125	l up to 200	l longer than 200	min.	max.	min.	max.	max.	min.			
M8	22	28	41	15.45	16.55	7.42	8	3.0	2.60	3.5	5.0	1.25
M10	26	32	45	18.35	19.65	9.42	10	3.2	2.72	4.2	5.5	1.50
M12	30	36	49	23.35	24.65	11.30	12	3.6	3.12	5.7	7.0	1.75
M16	38	44	57	31.20	32.80	15.30	16	4.2	3.72	7.5	9.0	2.00
M20	46	52	65	31.20	32.80	19.16	20	5.4	4.92	5.7	11.5	2.50
M24	54	60	73	37.20	38.80	23.16	24	6.6	6.02	6.7	13.0	3.00

nominal size	Length (l)	
	min.	max.
25	23.95	26.05
30	28.95	31.05
35	33.75	36.25
40	38.75	41.25
45	43.75	46.25
50	48.75	51.25
55	53.50	56.50
60	58.50	61.50

nominal size	Length (l)	
	min.	max.
65	63.50	66.50
70	68.50	71.50
75	73.50	76.50
80	78.50	81.50
90	88.25	91.75
100	98.25	101.75
110	108.25	111.75
120	118.25	121.75

nominal size	Length (l)	
	min.	max.
130	128.00	132.00
140	138.00	142.00
150	148.00	152.00

Diameter (d)	Length (l)																		
	25	30	35	40	45	50	55	60	65	70	75	80	90	100	110	120	130	140	150
M8	●	●	●	●	●	●	●	●	●	●									
M10	●	●	●	●	●	●	●	●	●	●									
M12	●	●	●	●	●	●	●	●	●	●	●	●	●	●	●	●			
M16		●	●	●	●	●	●	●	●	●	●	●	●	●	●	●	●	●	●
M20					●	●	●	●	●	●	●	●	●	●	●	●	●	●	●
M24							●	●	●	●	●	●	●	●	●	●	●	●	●

• Combinations available in the eShop | Other sizes on request

All technical data refer to the measure mm

